

ASSEMBLY INSTRUCTIONS

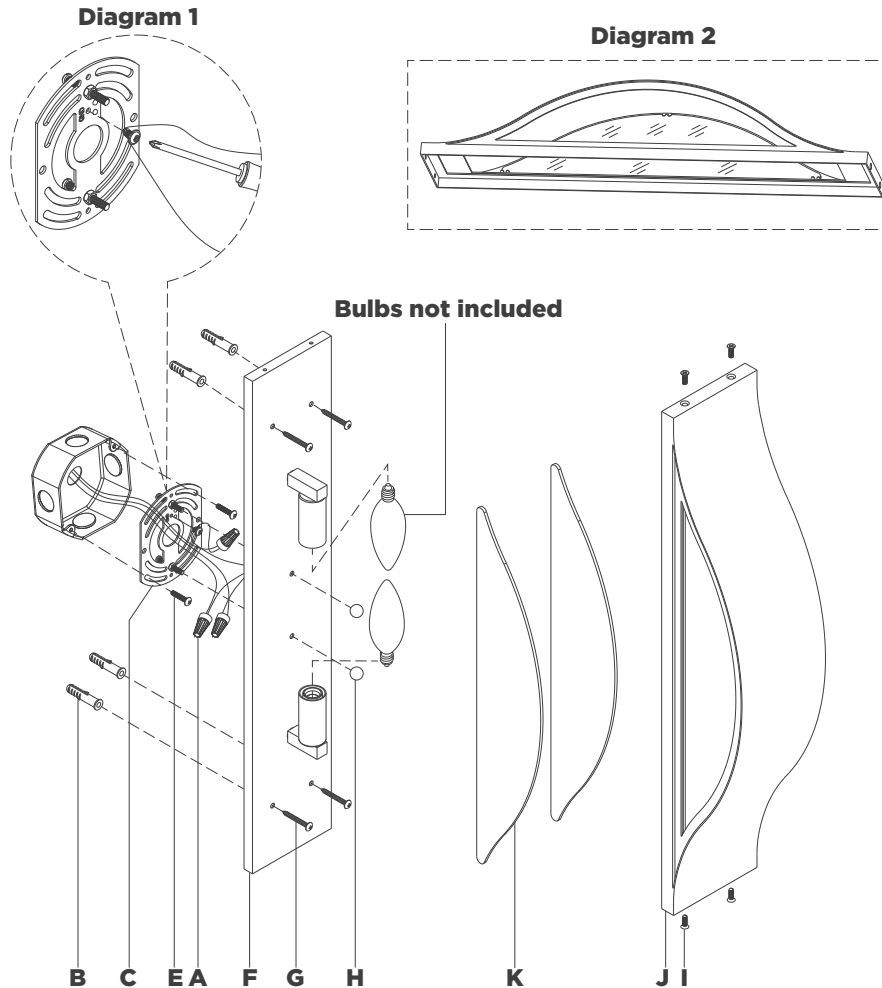

Avant Medium Linear Sconce

Item # KW2702

NOTICE:

This light fixture should be installed in accordance with all applicable, local installation codes, and by a person familiar with the construction and operation of it, as well as the hazards involved. Inspect item and contents carefully. If any damage or defect is found, do not install. Retain all packaging material until installation is complete and approved.

TOOLS REQUIRED (NOT INCLUDED):

Phillips Screwdriver

Slotted Screwdriver

Hammer

Pencil

Drill

1. Carefully remove all parts from the box. Place on a clean, soft surface.
2. Remove shade **(J)** from fixture body **(F)** by removing screws **(I)**.
3. Remove mounting plate **(C)** from fixture **(F)** by removing threaded caps **(H)**.
4. Using fixture **(F)** as a guide, line up with the junction box and mark anchor positions.
5. Using a drill bit slightly smaller than the anchor, drill holes in the marked positions. Install anchors **(B)** into the holes using a hammer.
6. Install mounting plate **(B)** to the junction box and secure with mounting screws **(C)**.
7. Wrap fixture ground wire (bare copper) around the green grounding screw (see diagram 1). Tighten. Continue fixture ground wire and connect to supply ground wire (usually green or bare copper) using wire nut **(A)**.
NOTE: It is imperative that the fixture is grounded.
8. Connect fixture neutral wire (white) to the supply neutral wire (usually white) using wire nut **(A)**.
9. Connect fixture hot wire (black) to the supply hot wire (usually black) using wire nut **(A)**.

NOTE: It is imperative that the fixture is grounded.

CAUTION: Do not reverse the hot and neutral connections.

ASSEMBLY INSTRUCTIONS

Avant Medium Linear Sconce

Item # KW2702

NOTICE:

This light fixture should be installed in accordance with all applicable, local installation codes, and by a person familiar with the construction and operation of it, as well as the hazards involved. Inspect item and contents carefully. If any damage or defect is found, do not install. Retain all packaging material until installation is complete and approved.

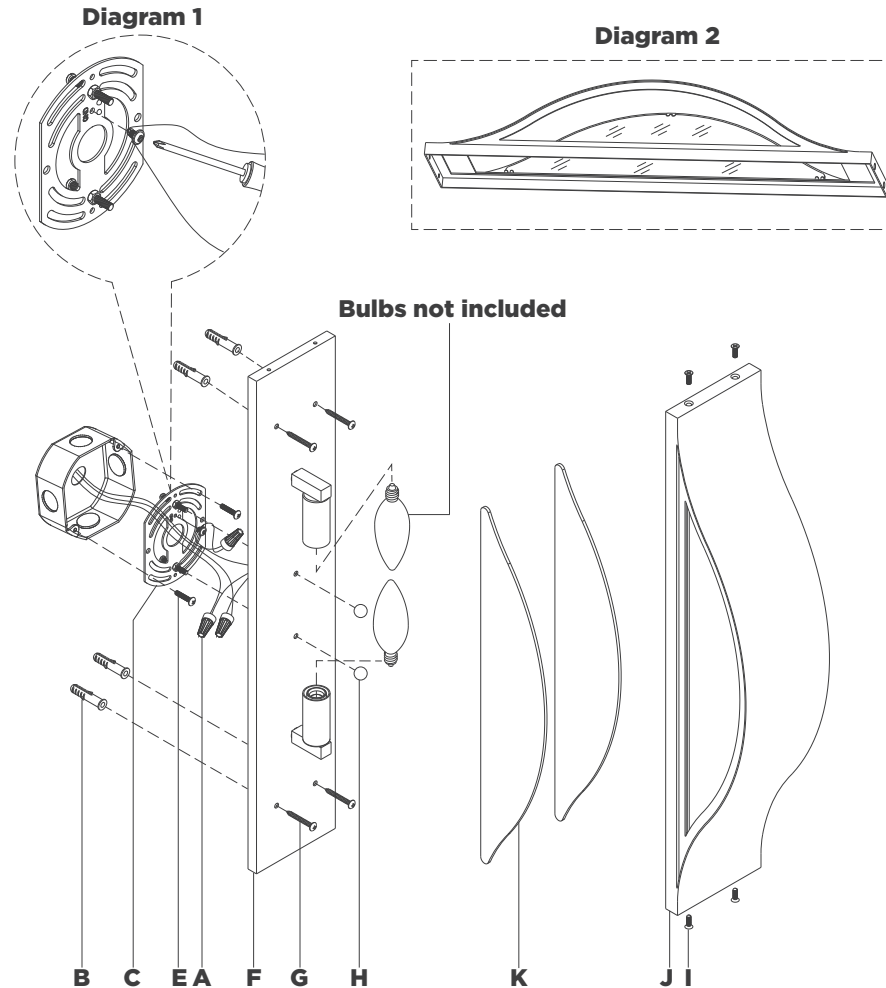

10. Make sure all wire connections are tight, then carefully tuck into the junction box.
11. Install fixture **(F)** to mounting plate **(C)** and secure with threaded caps **(H)**, then secure wood screws **(G)** to anchors **(B)**.
12. Install light bulbs into the sockets.
13. Attach glass diffuser **(K)** to shade **(J)** and secure by bending metal tabs (see diagram 2).
14. Attach shade **(J)** to fixture body **(F)** and secure with screws **(I)**.

CARE INSTRUCTIONS: Clean only with a soft dry cloth or feather duster. Do not use abrasive or chemical agents.