

Cordtlandt Flush Mount**AF1143, AF1153 | 1.0****VISUAL COMFORT & Co.**

STUDIO COLLECTION

GENERAL PRODUCT INFORMATION:

These fixtures are intended to be installed utilizing NEC compliant junction boxes.

This product is safety listed for damp locations.

Incandescent lamps may be dimmed with a standard incandescent dimmer.
LED lamps may be dimmed with a LED dimmer. Consult lamp manufacturer for additional information.

This instruction shows a typical installation.

CAUTION - RISK OF FIRE

This product must be installed in accordance with the applicable installation code by a person familiar with the construction and operation of the product and the hazards involved.

Use minimum 90°C supply conductors.

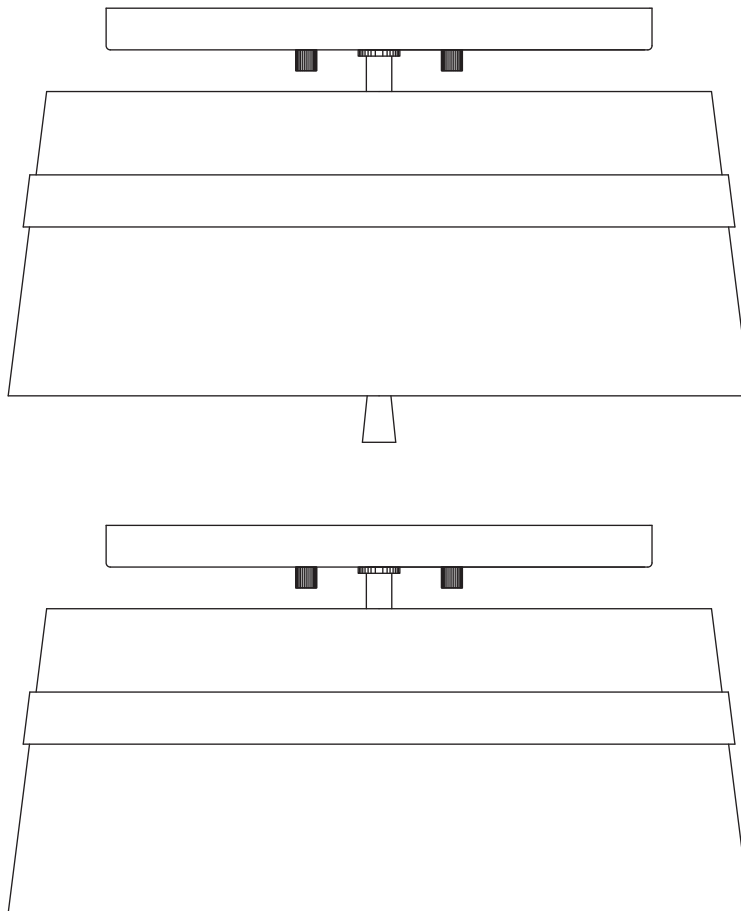
**SAVE THESE INSTRUCTIONS!**

Install the Fixture

IA

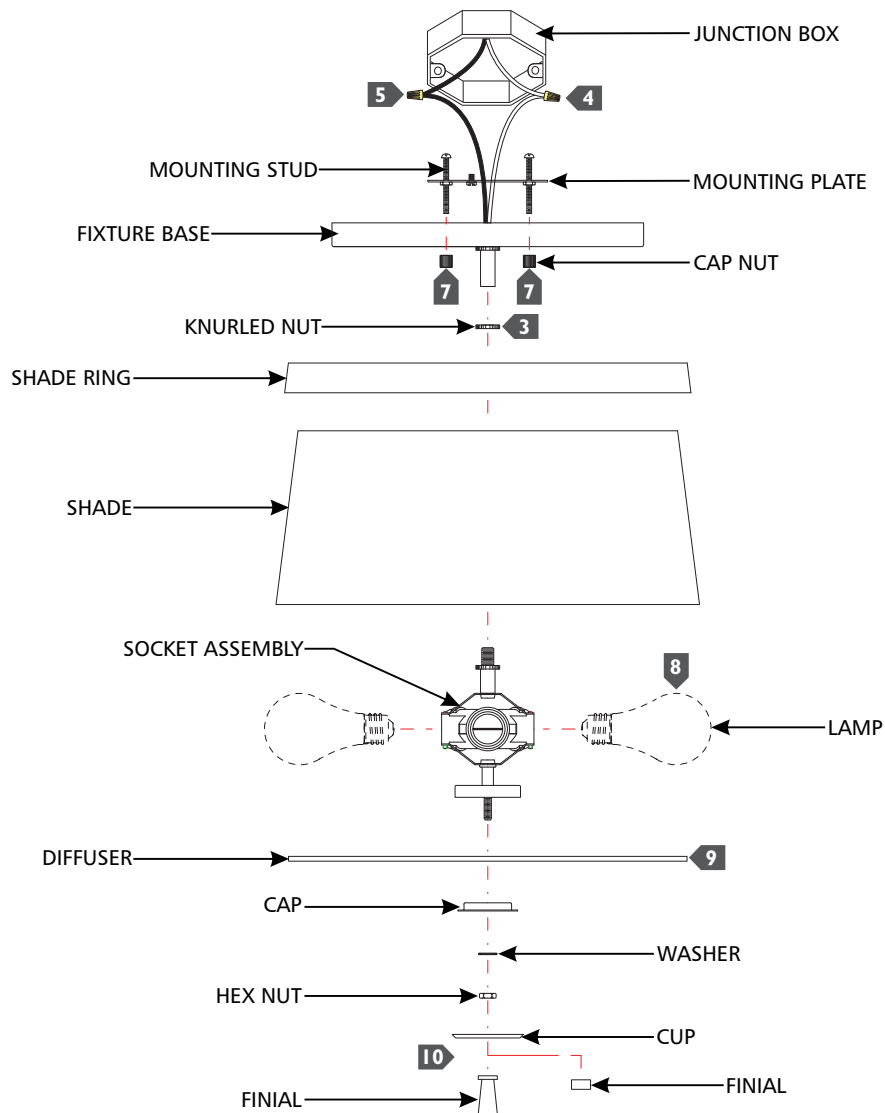

- 1** Secure the mounting plate to the junction box.
- 2** Feed the fixture wires through the shade, shade ring, and knurled nut in that order, then secure them together by screwing the knurled nut onto the socket assembly nipple.
- 3** Feed the fixture wires through the fixture base and screw it onto the socket assembly nipple.
- 4** Connect the fixture to a suitable ground in accordance with local electrical codes.
- 5** Connect the white fixture wire to the neutral power line wire with a wire nut.
- 6** Connect the black fixture wire to the hot power line wire with a wire nut.
- 7** Neatly tuck the wiring into the junction box, place the fixture base onto the mounting studs, and secure it in place by screwing the cap nuts onto the studs.
- 8** Screw the lamps into the sockets. Refer to the label on the socket for max wattage information.
- 9** Place the diffuser, cap, and washer onto the lower socket assembly nipple, then secure them in place by screwing the hex nut onto the nipple.
- 10** Place the cup onto the lower socket assembly nipple and secure it in place by screwing the desired finial onto the nipple.